

## Evolution Series

### Veneer Jamb – Rated (60 minutes)

**J1360A**

#### SINGLE RABBET JAMB (3/4")

- 1 1/8" (3 mm) hardwood edges
- 2 3/4" (19 mm) 60 min fire core
- 3 1/32" wood veneer face
- 4 5/8" (15.8 mm) hardwood door stop
- 5 Door
- 6 Corner rabbet type

#### SPECIFICATIONS

**MINIMUM WALL THICKNESS:** 4 5/8" (117 mm)

**ASSEMBLY:** Please refer to installation instructions

#### MAXIMUM OPENING

Single: 48" (1219 mm) x 96" (2438 mm)

Double: 72" (1829 mm) x 96" (2438 mm)

**CASING:** 5/8" (15 mm) x 2 1/2" (64 mm)

**SHIPPING:** Unassembled (Knock Down)

**WRAPPING:** Each frame will be shipped in a cardboard box, with 1/32" (1 mm) foam and bundle wrapped.

**Installation instructions and peel-and-stick door bumpers are included (mandatory)**

**WARRANTY: 3 years**

#### NOTE

Mounting brackets are suggested for proper installation.

Installation requires a wood casing of 1/4" x 1 1/2" minimum.

#### OPTIONS

- | Other configurations upon request
- | Mounting brackets available
- | Pre-machining
- | Pre-finishing
- | Subject to evaluation. Contact us.

#### LEED CONTRIBUTION OPTIONS

- | Recycled content
- | FSC (on request)
- | NAUF or ULEF (on request)

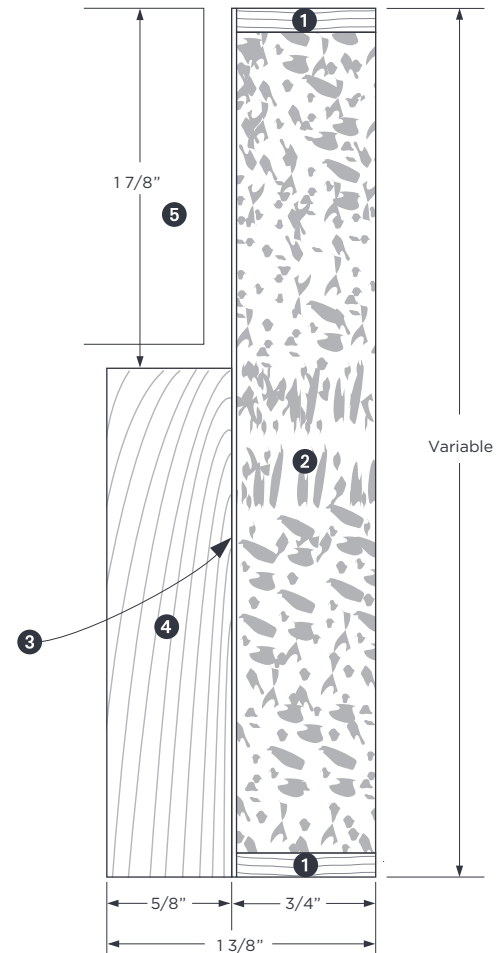

#### JAMB ASSEMBLY

Head and jamb

