

Evolution Series

Veneer Jamb – Rated (45 minutes)

J1345A

SINGLE RABBET JAMB (3/4")

- 1 1/8" (3 mm) hardwood edges
- 2 3/4" (19 mm) 45 min fire core
- 3 1/32" wood veneer faces
- 4 5/8" (15.8 mm) hardwood door stop
- 5 Door
- 6 Corner rabbet type

SPECIFICATIONS

MINIMUM WALL THICKNESS: 4 5/8" (117 mm)

ASSEMBLY: Please refer to installation instructions

MAXIMUM OPENING

- Single: 42" (1067 mm) x 96" (2438 mm)
- Double: 72" (1829 mm) x 96" (2438 mm)

CASING: 5/8" (15 mm) x 2 1/2" (64 mm)

SHIPPING: Unassembled (Knock Down)

WRAPPING: Each frame will be shipped in a cardboard box, with 1/32" (1 mm) foam and bundle wrapped.

Installation instructions and peel-and-stick door bumpers are included (mandatory)

WARRANTY: 3 years

NOTE

- Mounting brackets are suggested for proper installation.
- Installation requires a wood casing of 1/4" x 1 1/2" minimum.

OPTIONS

- Other configurations upon request
- Mounting brackets available
- Pre-machining
- Pre-finishing
- Subject to evaluation. Contact us.

LEED CONTRIBUTION OPTIONS

- Recycled content
- FSC (on request)
- NAUF or ULEF (on request)

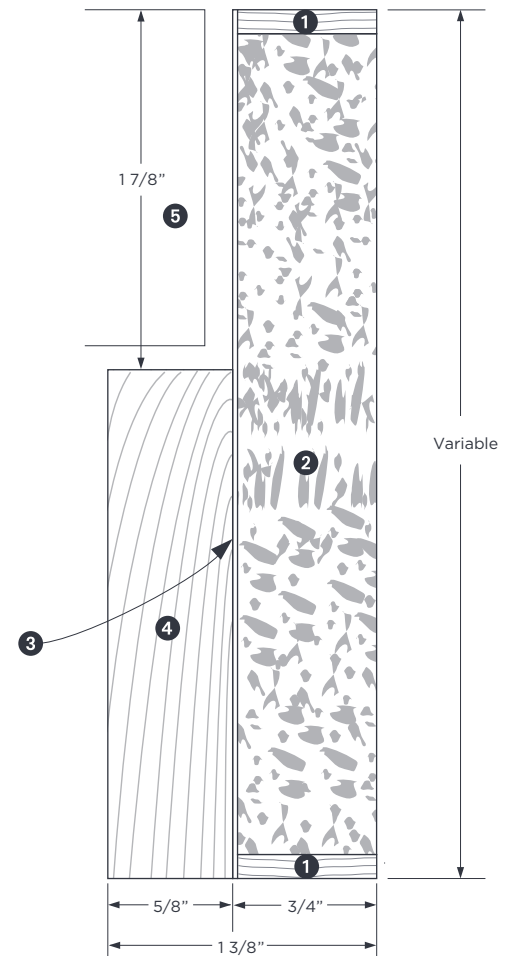

JAMB ASSEMBLY

Head and jamb

