

**SOUND RATED**  
(Heavy Duty)

**SR42-ME / SR4220-ME**

**SOUND RETARDANT DOORS 42 dB FOR INTENSIVE USE**

Our doors are certified and tested by Architectural Testing up to 48" X 96". Oversize constructions available without STC or fire label.

- 1 STILES:** 1 3/16" (30 mm) structural composite lumber with 7/8" (22 mm) hardwood matched with faces.
- 2 RAILS:** 3 5/16" (84 mm) at top and bottom.
- 3 CORE:** Sound dampening core
- 4 FACES:** Wood veneer (choice of face veneers; 2 ply plywood), hardboard panel or plastic laminate glued to composite crossband.

**GLUE:** Type 1 PVA Cross-link.

**INTERIOR** use

**SR42: SEAL COMPONENT KIT no. 10**

**WARRANTY: 3 years.**

**NOTE**

Dimensions are nominal before trimming.

**OPTIONS**

- 20 min fire rating: specify SR4220
- 45 min fire rating: specify SR4245
- Wood veneer glued to plywood veneer (3 ply plywood).

**WARNING**

Use of gaskets other than those tested may affect STC rating. Walls components, frame installation and joints can also impact STC ratings.

**IMPORTANT**

- Gaskets and threshold included.
- Limited dimensions.

**LEED CONTRIBUTION OPTIONS**

- EPD
- Recycled content
- FSC (on request)
- NAUF or ULEF (on request)

**PERFORMANCE MEASUREMENT**

- ANSI/WDMA 1.S.1A
- ASTM E 90-02, 413-87, E 1332-90, E 2235-03
- AWS
- Intertek WH-ETL
- NFPA 80

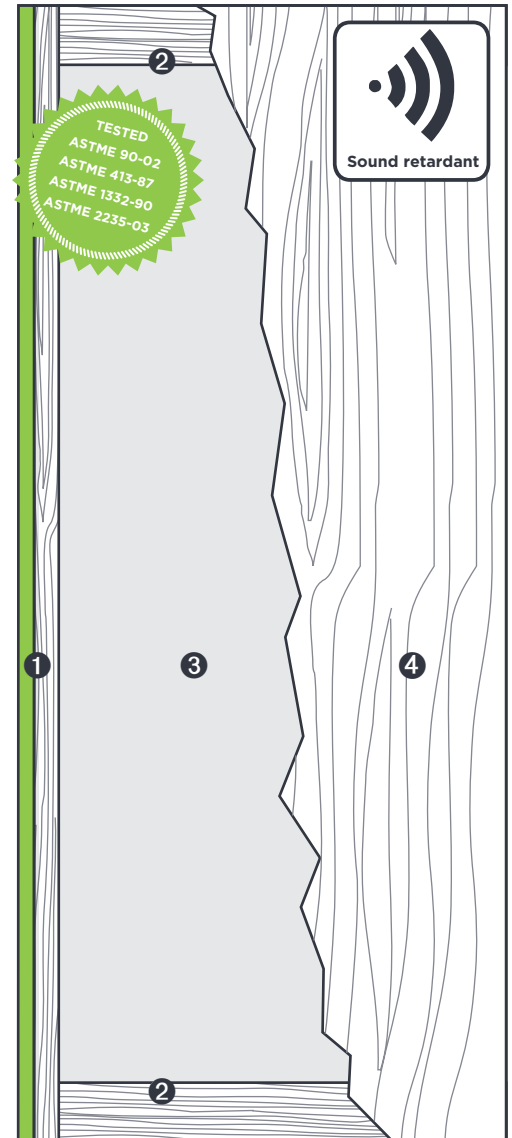

**1 STILES ME**

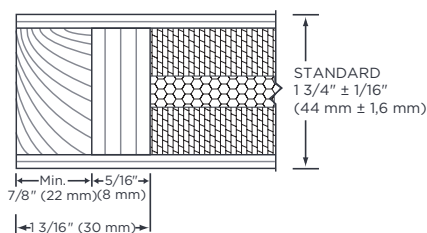

**2 RAILS**

