

# HOLLOW

(Extra Heavy Duty)

## 9500-ME (5 ply)

### ANTI-WARPING CONSTRUCTION FOR INTENSIVE USE

- 1 STILES:** 1/8" (3 mm) thick veneer, longitudinally laminated by hot pressing with type 1 structural glue, (LVL), including a 7/8" (22 mm) piece of hardwood, matched with faces, for a total width of 4 3/16" (107 mm).
- 2 TOP AND BOTTOM RAILS:** 1/8" (3 mm) thick veneer, longitudinally laminated by hot pressing with type 1 structural glue, (LVL) or laminated strand lumber (LSL), for a total width of 3 5/16" (85 mm).
- 3 CORE:** 4 3/4" (120 mm) honeycomb. (100% recycled).
- 4 FACES:** Wood veneer (choice of face veneers; 2 ply plywood), hardboard panel or plastic laminate glued to composite crossband.

**LOCK BLOCK:** Integrated.

**GLUE:** Type 1 PVA Cross-link.

**INTERIOR** use

**WARRANTY:** Lifetime

**NOTE**

| Dimensions are nominal before trimming

**OPTIONS**

| STC sound rating not available.

**LEED CONTRIBUTION OPTIONS**

- | Recycled content
- | FSC (on request)
- | NAUF or ULEF (on request)

**PERFORMANCE MEASUREMENT**

- | ANSI/WDMA 1.S.1A
- | ASTM-D1037 and 198-98 (LSL)
- | ASTM-D5456-93 (LVL)
- | AWS

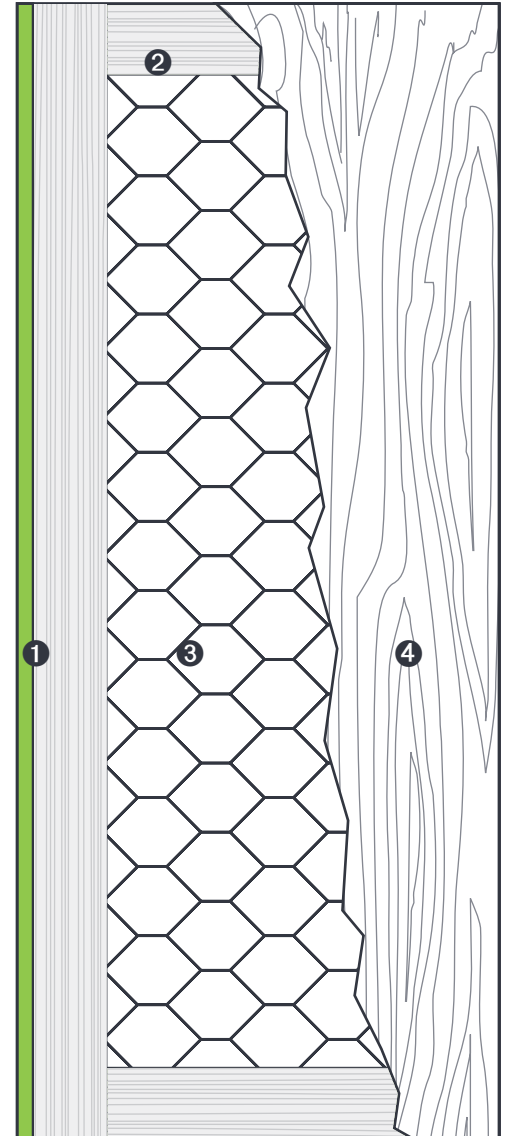

**1 STILES ME**

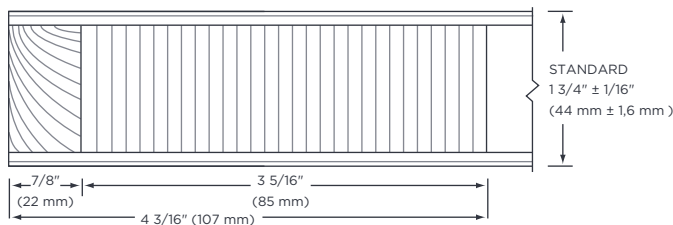

**2 RAILS**

