

**HOLLOW**  
(Standard Duty)

**9100-MO (5 ply)**

**FOR MODERATE USE**

- ❶ **STILES:** 1 3/16" (30 mm) clear, finger-jointed, low-density wood.
- ❷ **TOP AND BOTTOM RAILS:** 1 3/16" (30 mm) low-density wood or SCL, (LVL) or laminated strand lumber (LSL), manufacturer's choice.
- ❸ **CORE:** 4 3/4" (120 mm) honeycomb (100% recycled).
- ❹ **FACES:** Wood veneer (choice of face veneers; 2 ply plywood), hardboard panel or plastic laminate glued to composite crossband.

**LOCK BLOCK:** Lock materials manufacturer's choice. Low-density wood parts 4 1/4" (108 mm) wide x 20" (508 mm) long (including stile).

**GLUE:** Type 1 PVA Cross-link.

**INTERIOR** use

**WARRANTY:** 3 years

**NOTE**

| Dimensions are nominal before trimming.

**OPTIONS**

- | Lock block on both sides.
- | STC sound rating not available.

**LEED CONTRIBUTION OPTIONS**

- | Recycled content
- | FSC (on request)
- | NAUF or ULEF (on request)

**PERFORMANCE MEASUREMENT**

- | ANSI/WDMA 1.S.1A
- | ASTM-D1037 and D198-98 (LSL)
- | ASTM-D5456-93 (LVL)
- | AWS

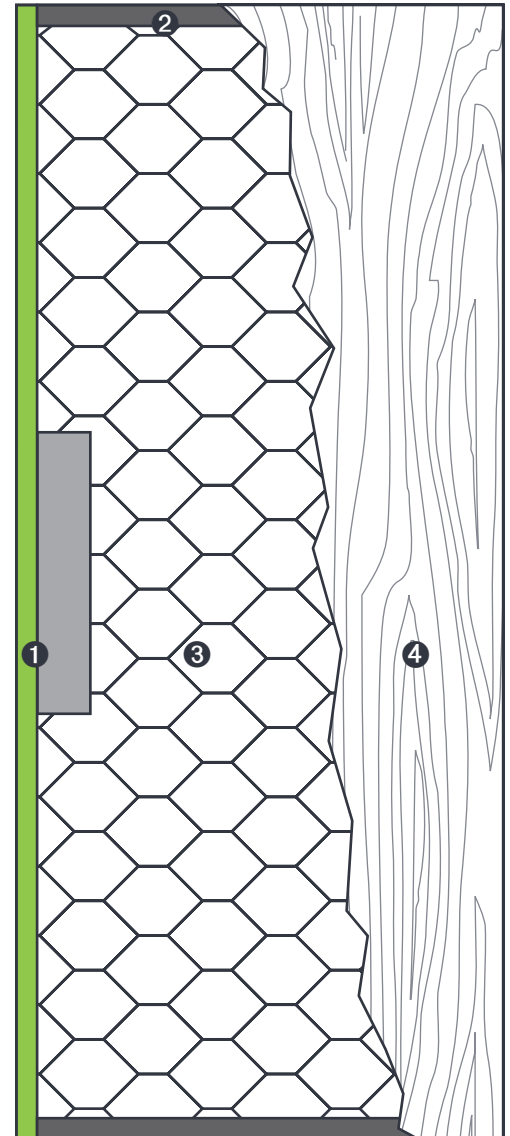

❶ **STILES MO**

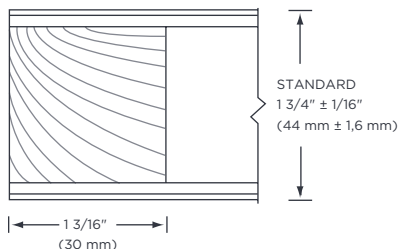

❷ **RAILS**

