

# 8100-MO (5 PLY)

## PARTICLE CORE

- ❶ **STILES:** 1 3/16" (30 mm) clear, finger-jointed, low-density wood
- ❷ **TOP AND BOTTOM RAILS:** 1 3/16" (30 mm) low density wood or SCL (LVL or LSL)
- ❸ **CORE:** Solid particleboard
- ❹ **FACES:** Wood veneer (choice of face veneers: 2 ply plywood), hardboard panel or plastic laminate glued to composite crossband

**LOCK BLOCK:** Integrated

**GLUE:** Type 1 PVA Cross link (UFF)

**INTERIOR USE**

**WARRANTY:** 3 years

### OPTIONS

- | 20 minute fire rating, specify 8120 MO
- | Wood veneer glued to veneer plywood (3 ply plywood)

### NOTE

| Dimensions are nominal before trimming.

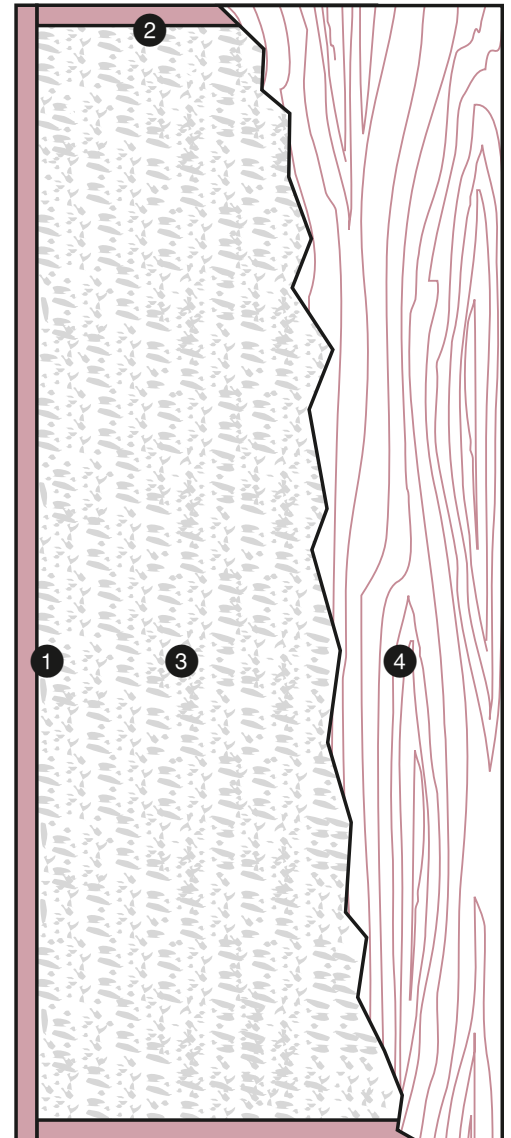

<b>LEED</b> ELIGIBLE CREDITS	4.1	4.2	M.R.		6.0	7.0	I.E.Q.
	✓	✓	5.1	5.2			4.4 (UFF)

### ❶ STILES MO

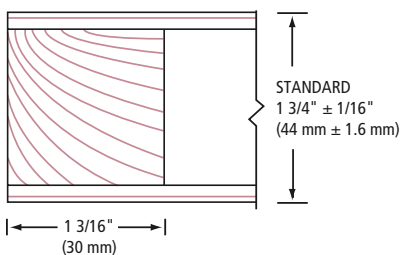

### ❷ RAILS

